

PLAN VIEW

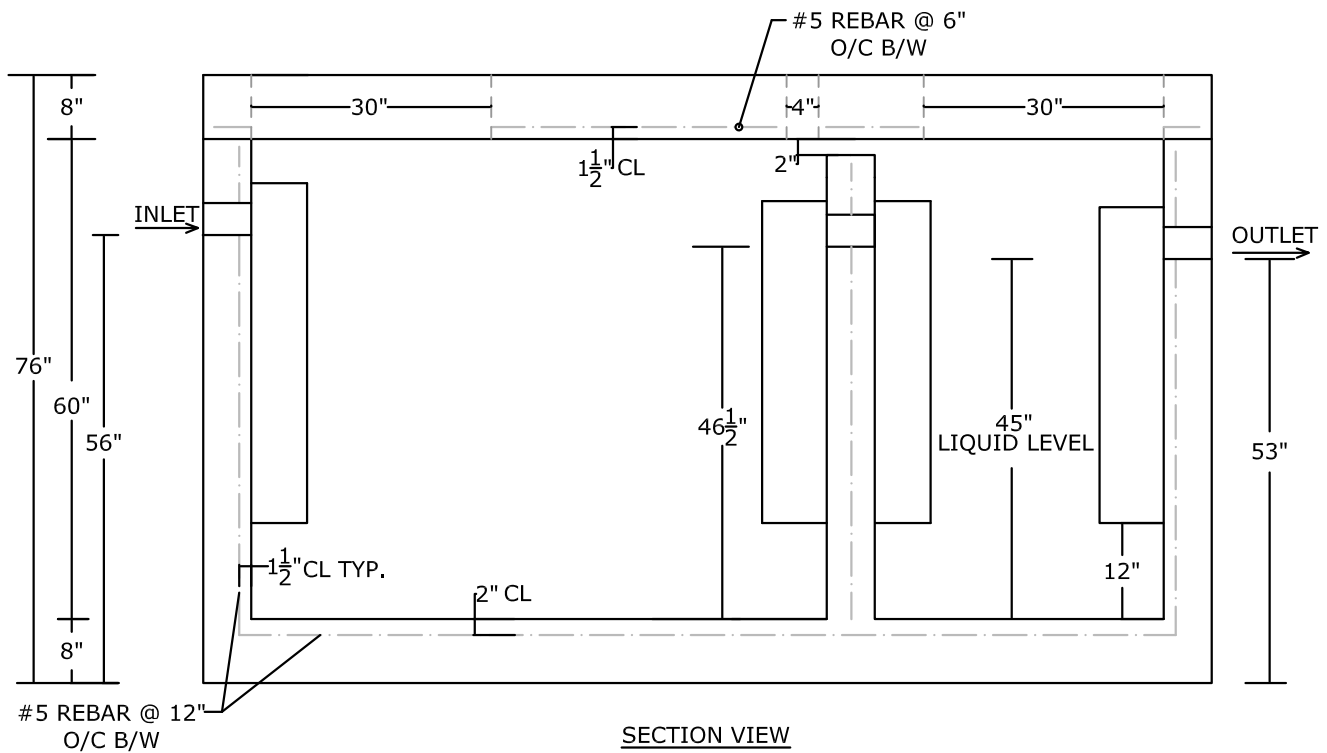

SECTION VIEW

NOTES:

- LOAD RATING: HS-20
- CONCRETE 5,000 PSI @ 28 DAYS
- REINFORCING: AS SPECIFIED, GRADE 60 REBAR
- INTERIOR COATED 2 COATS OF APPROPRIATE SEALER
- PLASTIC BAFFLES
- WEIGHT OF TANK BASE: 18,000 LBS. +/-
- WEIGHT OF LID: 5,500 LBS. +/-

PEERLESS CONCRETE PRODUCTS CO.		246 Main Street Butler, NJ 07405 973.838.3060p	
<i>SINCE 1959</i>		www.peerlessconcrete.com	
sales@peerlessconcrete.com		www.peerlessconcrete.com	
1000 GALLON HEAVY DUTY GREASE TRAP/ OIL SEPARATOR (2 COMPARTMENT)			
CUSTOMER:			
PROJECT:			
SCALE: N.T.S.	DATE: 12/2023	EST#:	G-3